







CASEMENT

Thermally broken window that allows for both side hung and top hung outward openings. This solution, with a thermal break zone of 32 mm and a transmittance U_w from 0.9 W/m^2K , has the British security certification PAS 24, being especially suitable for this market.

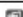
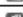
FEATURES

Transmittance		$U_w \geq 0.9$ (W/m^2K)
Acoustic insulation		Rw up to 45 dB
Air permeability		Class 4
Watertightness		Class E1200
Wind resistance		Class CE 2400
Security test	 	Passed

Reference test: 1.44 x 1.33 m / 1 sash + 1 fixed light
Security test: Reference test: 1.44 x 1.33 m / 1 sash + 1 fixed light

POSSIBILITIES



OPENING POSSIBILITIES



Outward Opening
Side hung
Top hung

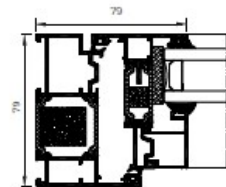

* Flush Version

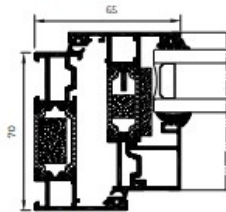

* Standard Version



Thermally broken 

Sightlines

Frame 70 mm, Sash 70 mm

Polyamide Strip Length
32 mm

Profile Thickness

Window 1.6 mm

Glazing

Max. 44 mm, Min. 23 mm

Maximum Sash Dimensions

Slim Sash (Side Hung):

Width [L] 950 mm, Height [H] 1300 mm

Slim Sash (Top Hung):

Width [L] 1200 mm, Height [H] 1300 mm

Heavy Duty Sash (Side Hung):

Width [L] 750 mm, Height [H] 1750 mm

Heavy Duty Sash (Top Hung):

Width [L] 1800 mm, Height [H] 1800 mm

Maximum Sash Weight

Side Hung Slim Sash: 35 kg

Top Hung Slim Sash: 50 kg

Side Hung Heavy Duty Sash: 42 kg

Top Hung Heavy Duty Sash: 100 kg

Consult maximum weight and dimensions according to typologies



CASEMENT