

4700 IN-LINE SLIDER / LIFT & SLIDE

SYSTEM

Sightlines

Frame depths 115 and 120 mm, 185 mm 3 rails

Interlock 47 mm

Polyamide Strip Length

20-25 mm

Profile Thickness

Balcony 1.5 mm

Glazing

Max. 36 mm, Min. 26 mm

Maximum Sash Dimensions

Width (L) 2500 mm, Height (H) 3000 mm

Maximum Sash Weight

Slide 280 Kg

Lift & Slide 300 Kg

Consult maximum weight and dimensions according to typologies



4700 IN-LINE SLIDER / LIFT & SLIDE SYSTEM



This sliding system, available both in-line slider and lift & slide versions, becomes an ideal solution for closing large spans. It presents modern aesthetics in straight lines, a reduced interlock section and large glazed surfaces that ensure bright and comfortable areas, due to its thermal and acoustic performance.



- Up to 3 meters height
- Maximized glazed surface
- 47 mm interlock
- Faster manufacturing
- High security

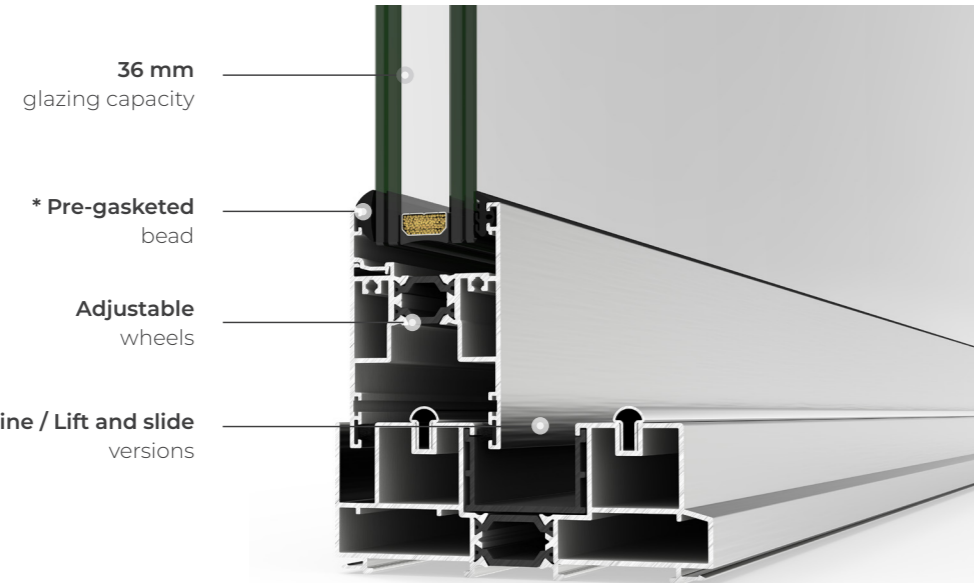

BFRC Rating
kWh/(m²·yr)

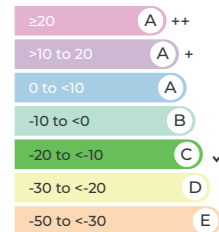

Double glazing

BFRC Rating
kWh/(m²·yr)

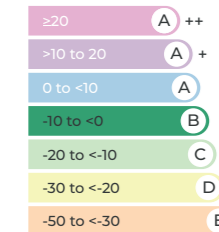

Triple glazing

* Available for 28 mm glazing only



FEATURES

U value (I)		Double glazing * Uw from 1.4 (W/m ² K)	Triple glazing * Uw ≥ 1.2 (W/m ² K)
Acoustic insulation		Rw up to 40 dB	
Air permeability		Class 3* / 4**	
Water tightness		Class 7A	
Wind resistance		Class C5* / C2**	
Security test		PAS24 ✓ Passed	

Double glazing Ug=1.0 / Triple glazing Ug=0.7
(I) Two sashes 5 m x 3 m



In-line Slider



Lift & Slide

* Reference slide test 1.8 x 2.2 m / 2 sashes / ** Reference lift & slide test 4.0 x 2.50 m / 2 sashes
Security test: Reference test 2.40 x 2.40 m / 2 sashes

IN-LINE SLIDER

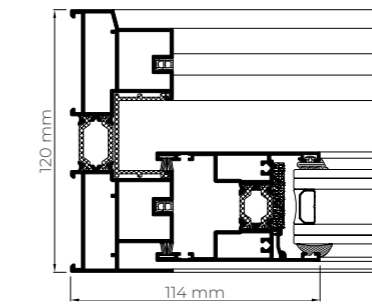

LIFT & SLIDE

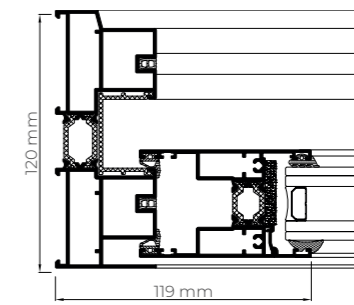

47 mm interlock

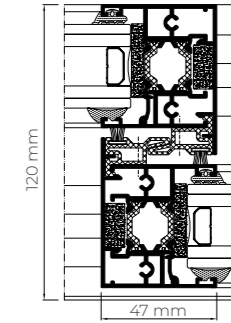

100 mm interlock

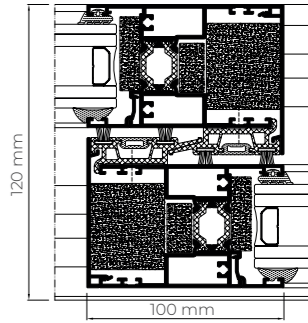

DRAINAGE SOLUTIONS

Hidden Drainage

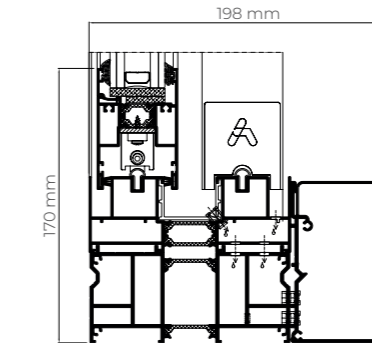

250 mm Subcill

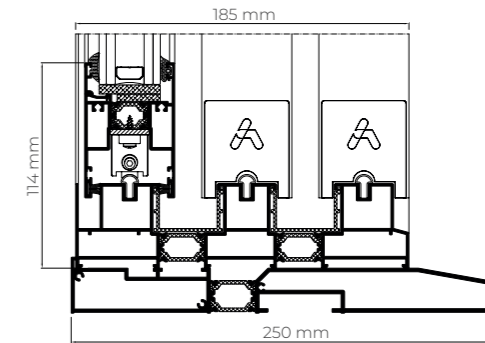

HEAD EXTENSION - 38 mm

Double Track

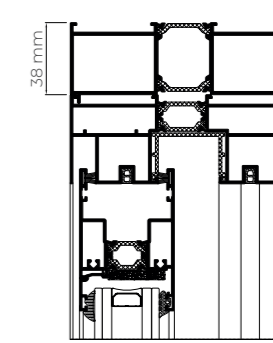

Triple Track

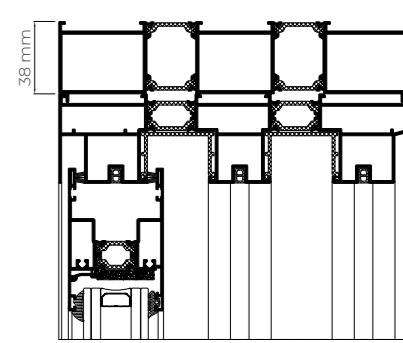

OPENING POSSIBILITIES

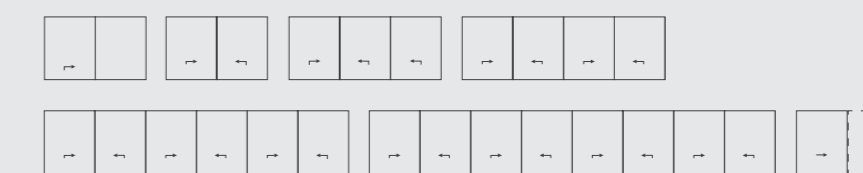

Sliding
1 rail (1 sash + 1 fixed light)
2, 3 & 4 rails
In-pocket

POSSIBILITIES



ACCESSIBILITY